



Pas Reform Air piping for SmartSetPro™ setter

For clean, uninterrupted fresh air to the setters



Royal Pas Reform
Integrated Hatchery Solutions



Air Piping for SmartSetPro™ setter

Benefits

Fresh, conditioned air from the plenum box, or setter corridor, is transported to the setter units through the air piping set. Special dividers feed the air equally to each section of the machine, resulting in maximum efficiency of air flow per setter section.

How it works

- Fresh air from the Air Handling Unit is transported to the air plenum box, or the setter corridor
- The air is transported to each section individually, via the central air-dividing duct
- Dirty, used air from the setter air outlet is fully separated from the clean air, preventing cross contamination

Related products

- ▶ Air Handling Unit
- ▶ Air plenum box

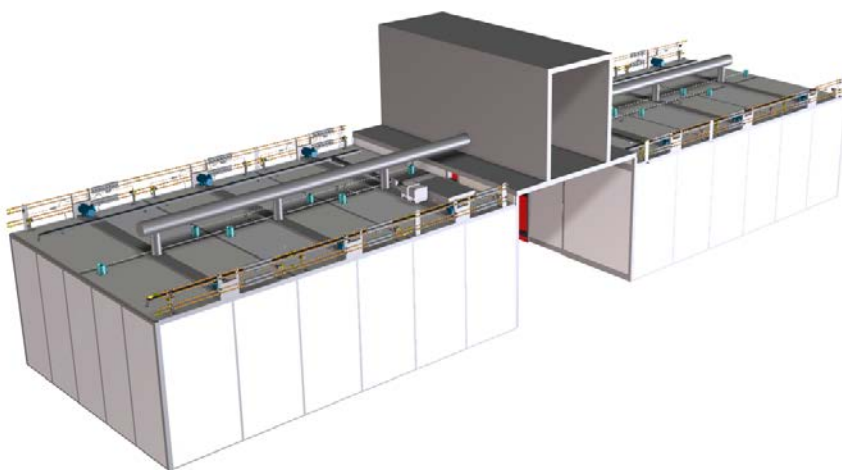

Technical Specifications

- | | |
|------------|--|
| Material | > Galvanized Spiro ducting |
| Dimensions | > Diameter Main ducting 250 mm
> Coupling 160 mm |
| Weight | > 25-30 Kg |
| Including | > Air ducting from air inlet box to sectional inlet valves
> Adaptor from round ducting to the incubator air inlet
> Air inlet box behind louvre grill (louvre grill not included) |



Royal Pas Reform

Integrated Hatchery Solutions

Bovendorpsstraat 11
7038 CH Zeddum
The Netherlands

Phone +31 314 659 111
info@pasreform.com
www.pasreform.com